

# PRODUCT OF THE MONTH

## Sikaflex® PRO

High Performance, High Flexibility,  
Multipurpose Sealant



Sealing Solutions for Joints in Industrial Floors



Sealing Solutions for Floor Joints in Clean Rooms



Sealing Solutions for Joints in Car Parks



Sealing Solutions for Floor Joints in Industrial Kitchens



Sealing Solutions for Floor Joints on Balconies



Sealing Solutions for Specialty Joints in Containment Bunds



Sealing Solutions for Joints in Concrete Pavements



Sealing Solutions for Floor Joints in Pedestrian Areas



### One Way Construction Joint

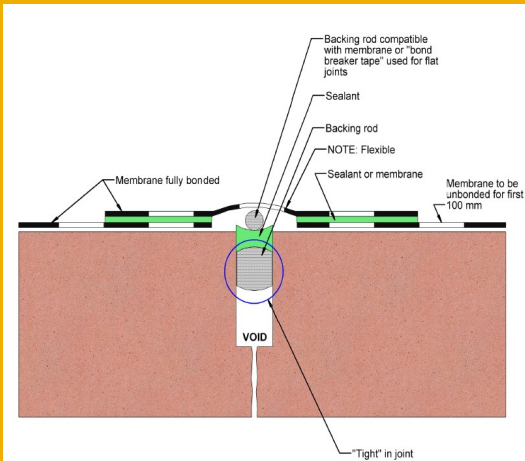

### JOINT SEALANT INSTALLATION

Refer to the appropriate PDS to ensure correct solution for specific application.

**Joint Preparation** : ensure joint is clean, sound, dry & free of oil, grease & contaminants. Tape joints to ensure a cleaner caulk line.

**Priming** : Refer to Primer Selection Guide for detailed information to ensure correct Primer is selected.

**Application** : Install Correct size BACKING ROD. When applying sealant avoid air entrapment.

**Tooling Off** : Will help force the sealant into the joint. Final tooling off can be done with a spatula dipped in 20% washing up detergent in water.

**Cleaning** : Use Sika Colma Cleaner to remove uncured sealant from tools etc.;

PEDESTRIAN TRAFFIC FLOOR JOINTS (Sealant is Floor Level)

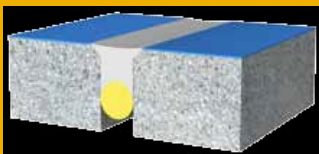

HIGH TRAFFIC FLOOR JOINTS (Sealant is recessed)



BUILDING TRUST



CONCRETE PROTECTION  
PTY LTD

155 Barkly Avenue, Burnley, Victoria. 3121

Tel: 03 9429 3377 Fax: 03 9427 0745

Email: info@conpro.com.au

Web: www.conpro.com.au