

Waterproofing Bathrooms



CONCRETE PROTECTION
WATERPROOFING SOLUTIONS



Old floors and cement sheeting may require a vapour barrier preparation



Prior to waterproofing the bathroom, some floors may require a vapour barrier to be installed. The vapour barrier to stop moisture from below lifting the waterproofing membrane.

Two part water based epoxy products are ideal for this purpose.



Materials for the job



- Poly urethane for corking
- poly cloth reinforcing fabric
- Fibreflex waterproofing membrane





Cut in joints

- cork joints with poly urethane
- apply reinforcing fabric



1 Apply Fibreflex to surface and lay Polycloth into the corners, smoothed into the wet surface



2 Apply a coat of Fibreflex over the surface of the Polycloth ensuring the coating penetrates the fibres of the Polycloth



3 Repeat the process for the vertical corners



4 Apply a second coat of Fibreflex to the entire area



Membrane covering walls and floor



Coat entire shower area

Two coats over walls and floor



Reference diagrams from the Standard AS3740 – waterproofing of wet area within residential buildings

Shower Base

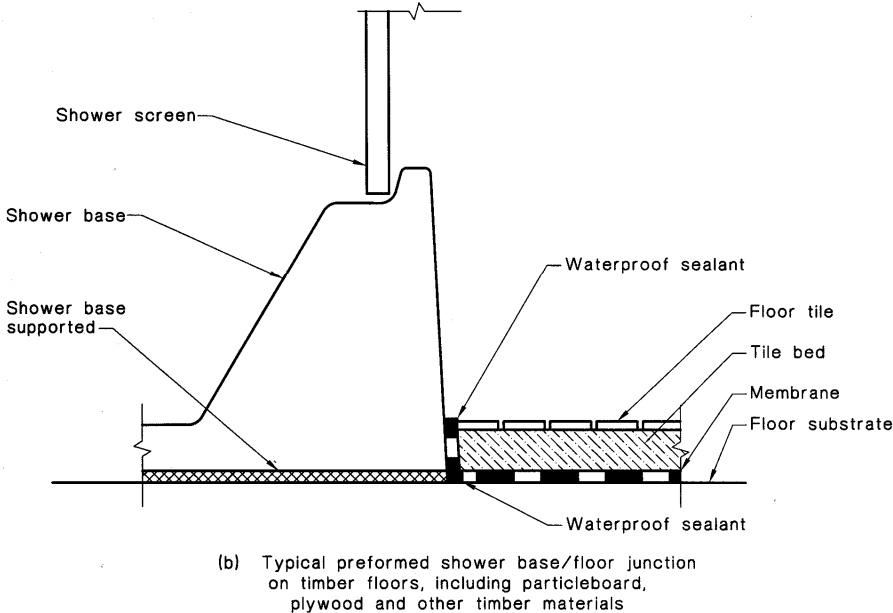
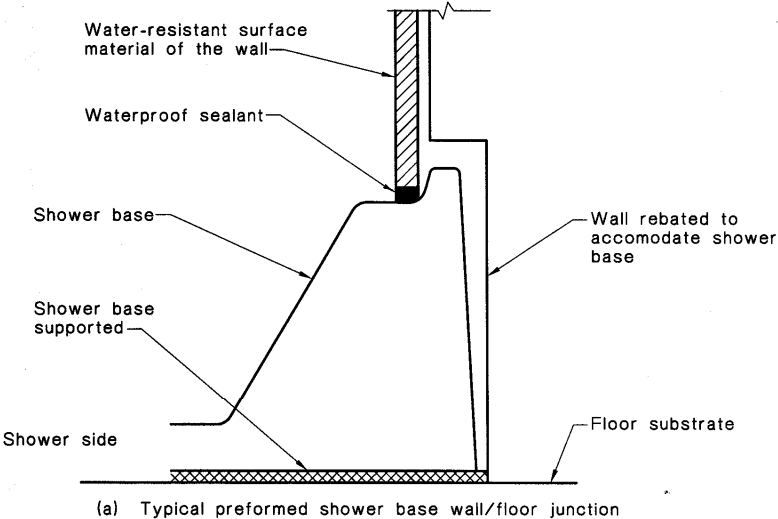
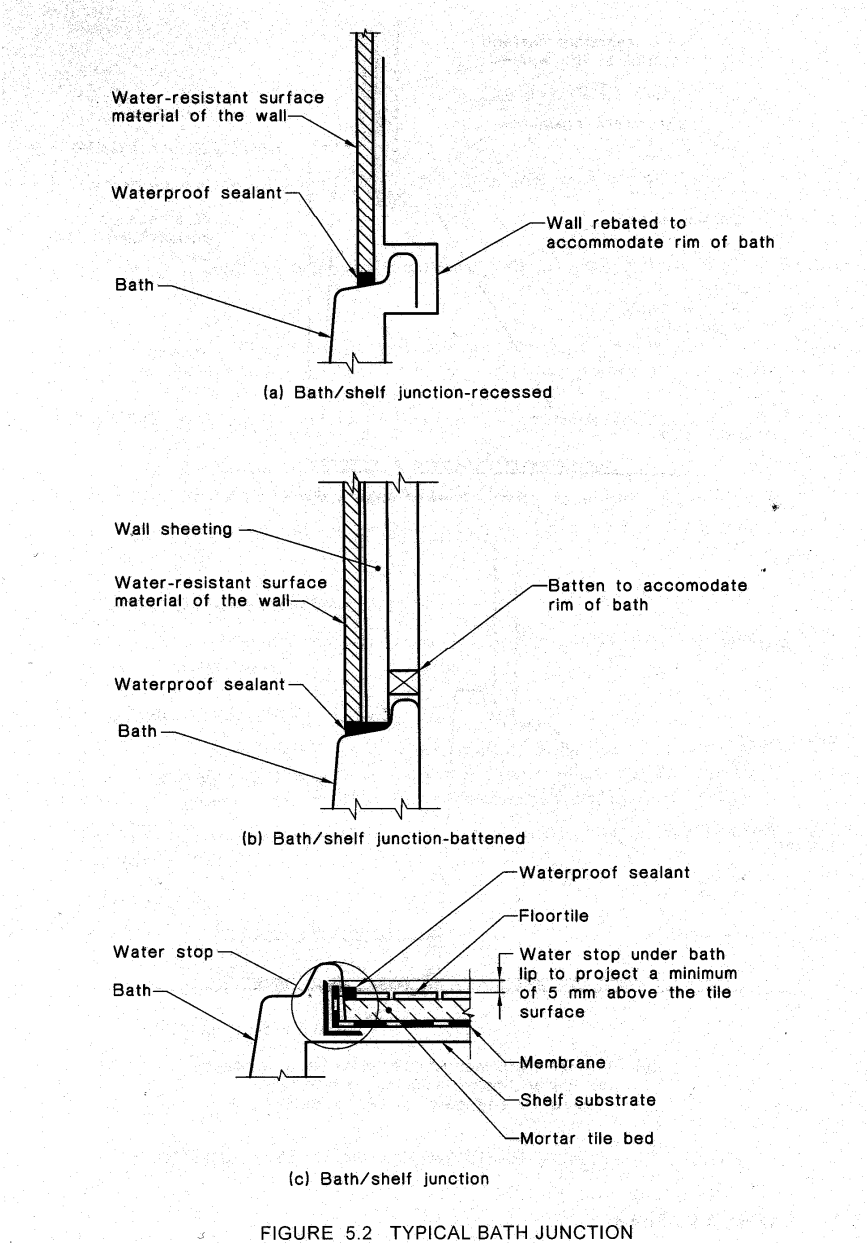

FIGURE 5.1 TYPICAL PREFORMED SHOWER BASE JUNCTIONS

AS3740 – waterproofing of wet area within residential buildings

Bath Junction



AS3740 – waterproofing of wet area within residential buildings

Minimum Membrane coverage

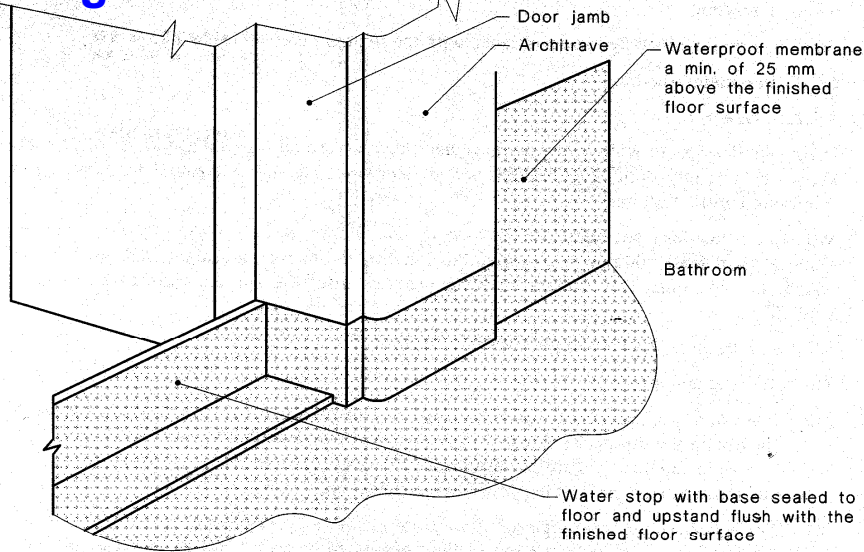

(a) After installation of architrave

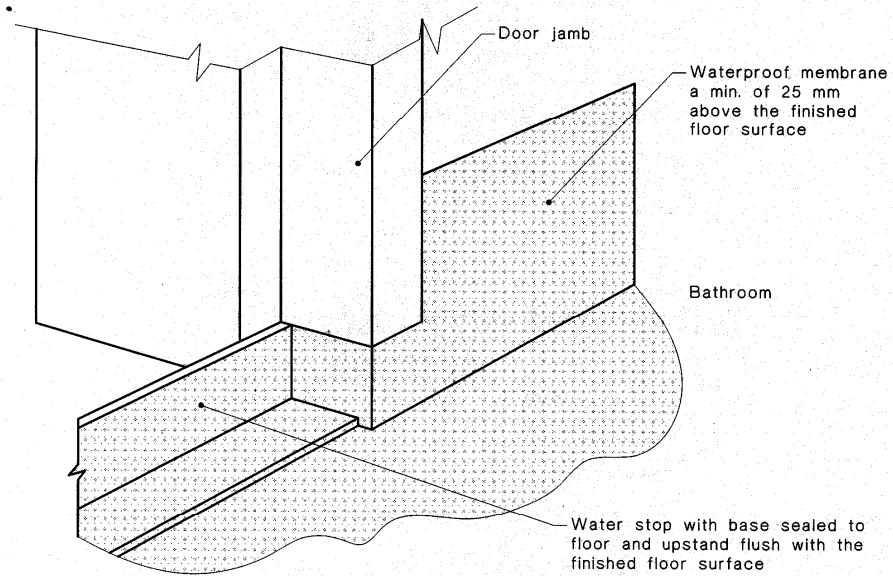

(b) Prior to installation of architrave

FIGURE 5.3 TYPICAL BATHROOM DOOR DETAIL FOR WHOLE BATHROOM WATERPROOFING



AS3740 – waterproofing of wet area within residential buildings

Stepped down Shower Construction

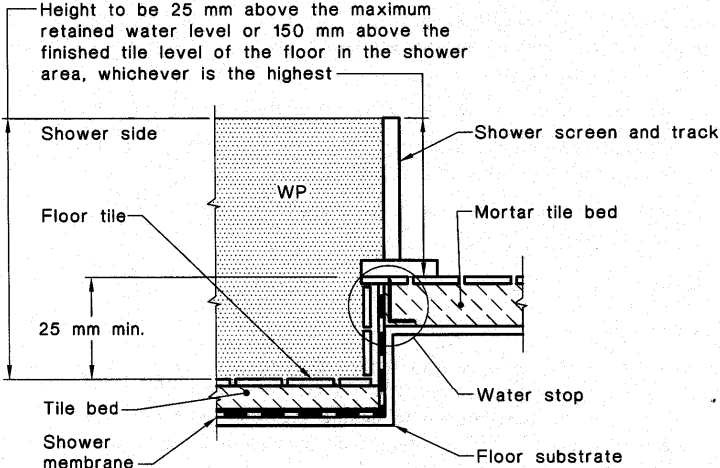

(a) Enclosed shower—Membrane below tile bed

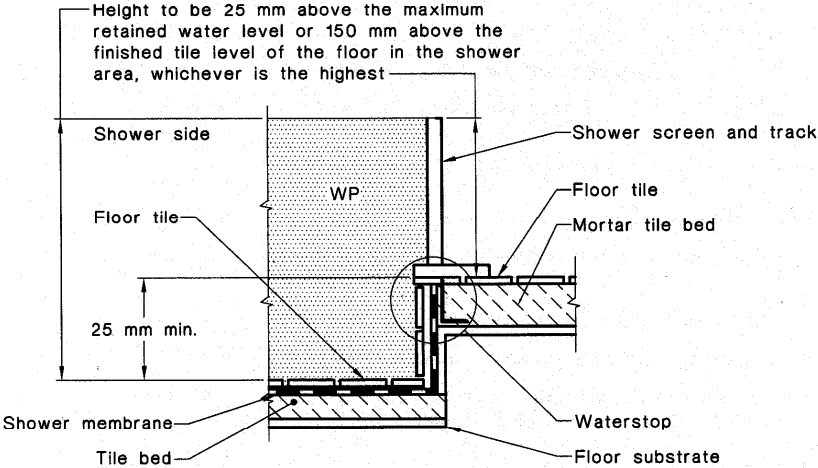

(b) Enclosed shower—Membrane above tile bed

FIGURE 5.4 (in part) TYPICAL STEPPED DOWN SHOWER CONSTRUCTION



AS3740 – waterproofing of wet area within residential buildings

- Drainage termination
- Hob construction
- Hobless construction

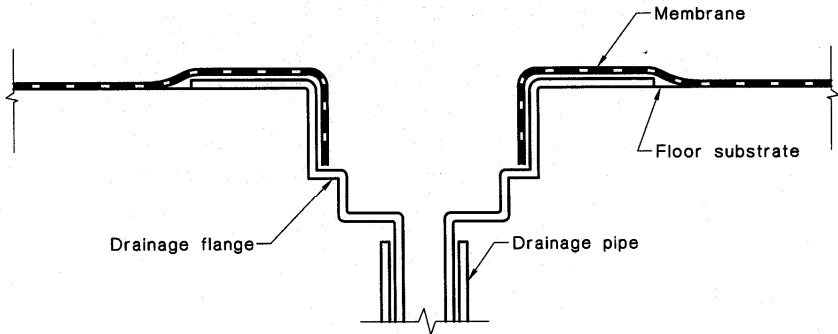

FIGURE 5.10 TYPICAL MEMBRANE TERMINATION AT DRAINAGE OUTLET

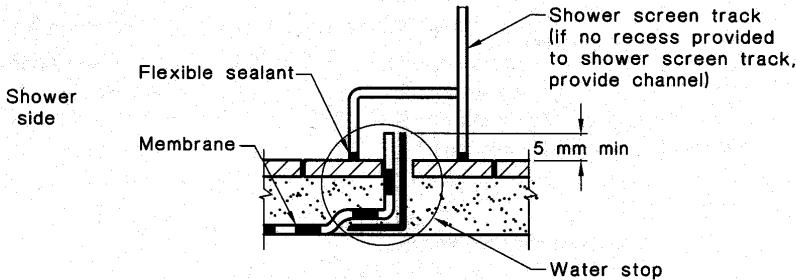

FIGURE 5.8 TYPICAL HOBLESS CONSTRUCTION

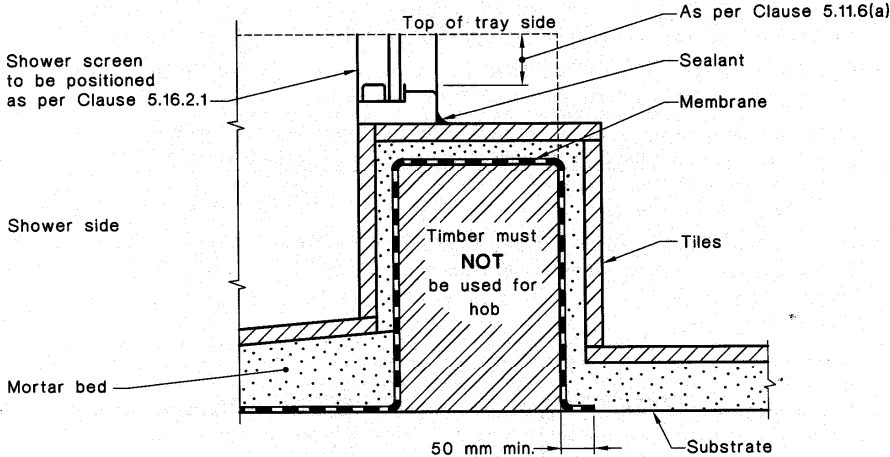
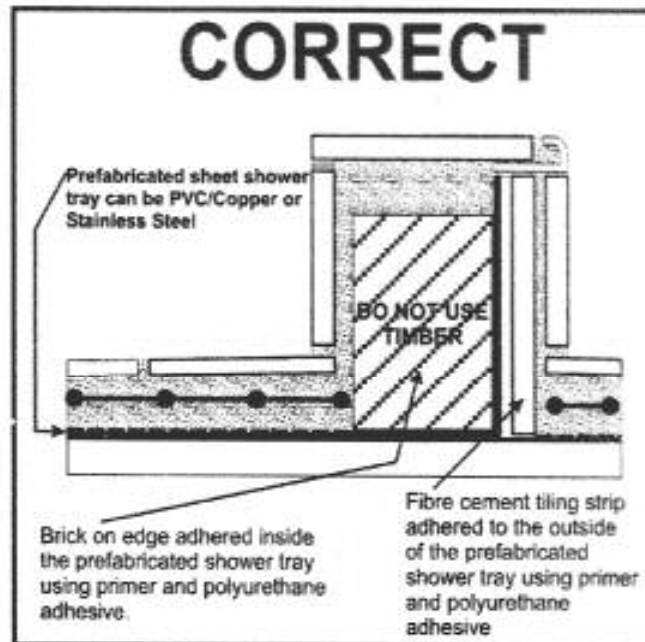
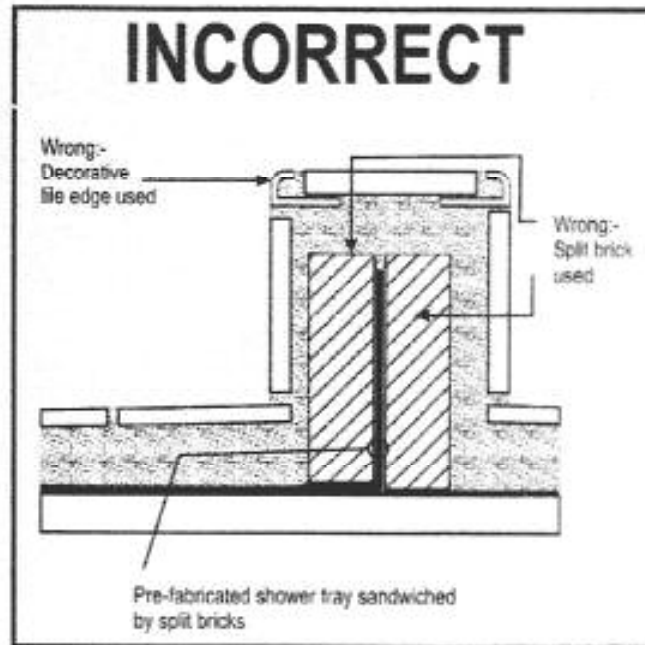

FIGURE 5.11 TYPICAL HOB CONSTRUCTION—INTERNAL MEMBRANE



Example 2. Defective hob installation in sheet membranes



Example 5. Defective step down shower using a liquid applied membrane

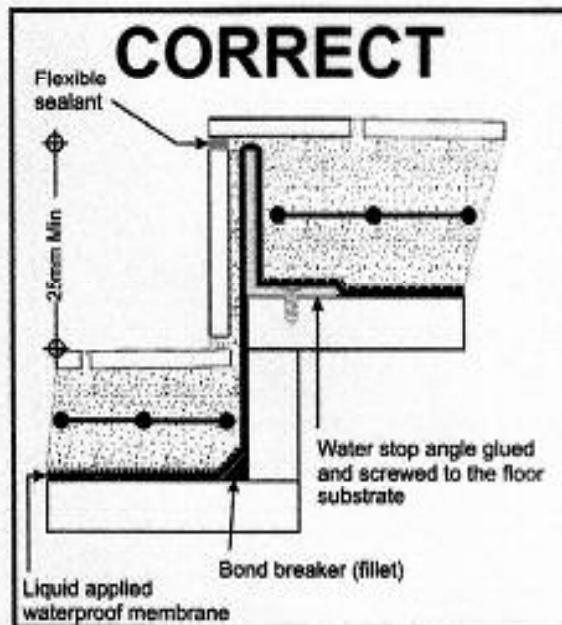
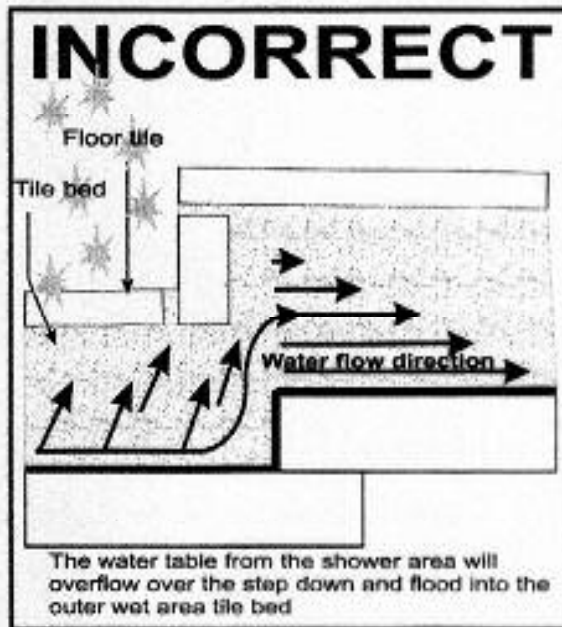

Example 6. Defective hobless shower liquid applied membrane

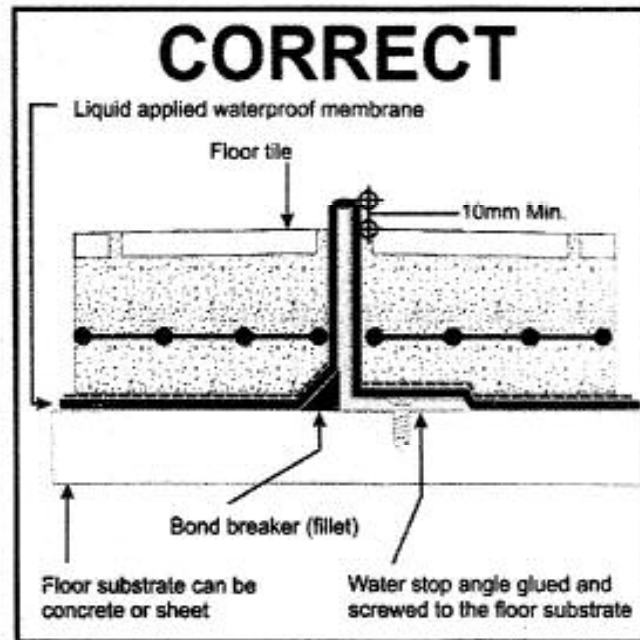
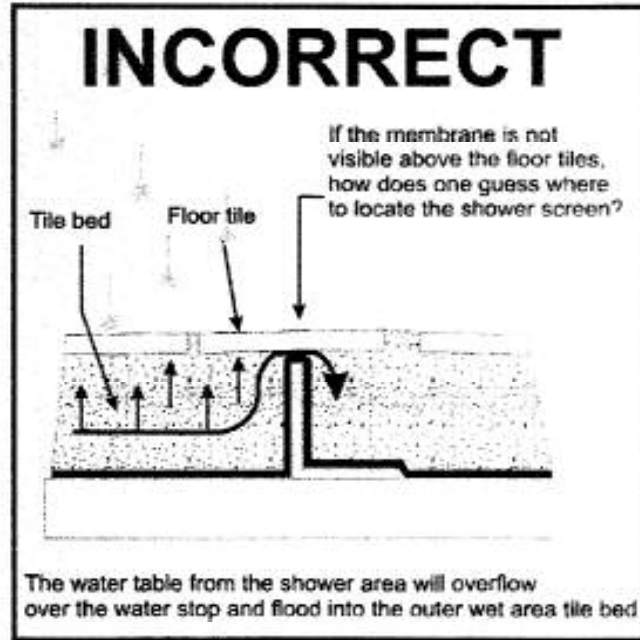

Figure 14. Typical liquid applied membrane termination detail into drainage pipe where the membrane has been applied over the tile screed

