

Check List

The following provides a check list to record that the job has been completed satisfactorily

Tick
acceptance

Good condition of floor substrate	<input type="checkbox"/>
Thorough caulking of joints	<input type="checkbox"/>
Application of bond breaker tape	<input type="checkbox"/>
Fabric reinforcing in shower joints	<input type="checkbox"/>
Fabric reinforcing for bath joints	<input type="checkbox"/>
Fabric reinforcing for floor/wall joints	<input type="checkbox"/>
Shower zone membraned	<input type="checkbox"/>
Bath zone membraned	<input type="checkbox"/>
Vanity zone membraned	<input type="checkbox"/>
Walls membraned up to 100mm	<input type="checkbox"/>
Floor membraned	<input type="checkbox"/>
Membrane over screed before tiles	<input type="checkbox"/>

Comment:

Site name:

Site Address:

Applicator sign off:



Distributed By:



**MANUFACTURED BY:
CONCRETE PROTECTION PTY LTD**

155 Barkly Avenue
Burnley, Victoria 3121
Australia

Phone: 61 3 9429 3377
Fax: 61 3 9427 0745
E-mail: info@conpro.com.au
Web: www.conpro.com.au



**MANUFACTURED BY:
CONCRETE PROTECTION PTY LTD**

Right Product, Right Advice, Right Price



Shower zone in photo shows only one coat of membrane

**Application guide to meet
Australian Standards
AS 3740**



Waterproofing

As with most jobs, preparation is the key to a good finished result.

First become familiar with the AS 3740 to comply to regulations.

The advice in this brochure is a guide, making the assumption that the floors and walls have been constructed to manufacturers and building standards.

Refer our web site for Conditions of Sale and usage.

MATERIALS

Waterproofing Sealant: Poly Urethane similar to SIKAFLEX PRO (don't use silicon)

Bond Breaker: apply a separate tape or use poly urethane as the bond breaker

Reinforcing Cloth: all corner joints need protection with POLYCLOTH or stranded fiberglass matting

Liquid Waterproofing Membrane: FIBREFLEX Internal waterproofing membrane. Certified Class II membrane,

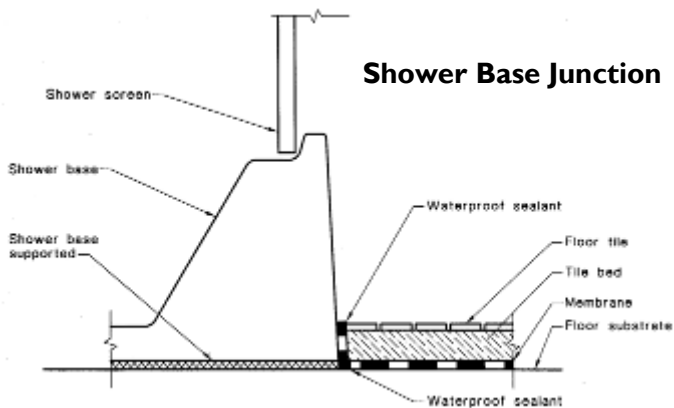

Bathrooms

CUT IN JOINTS

Building movement will occur at the joints. Start the job with poly urethane into the horizontal and vertical joints, then apply reinforcing fabric and membranes as indicated below



1 Apply Fibreflex to surface and lay Polycloth into the corners, smoothed into the wet surface

2 Apply a coat of Fibreflex over the surface of the Polycloth ensuring the coating penetrates the fibres of the Polycloth

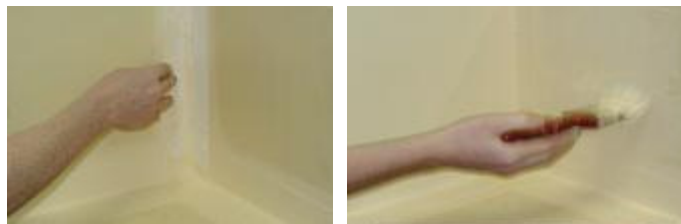

3 Repeat the process for the vertical corners

4 Apply a second coat of Fibreflex to the entire area

TERMINATE MEMBRANE IN DRAIN

The liquid applied waterproofing membrane terminates down into the waste outlet and permanently bonds to the bore of the drainage pipe

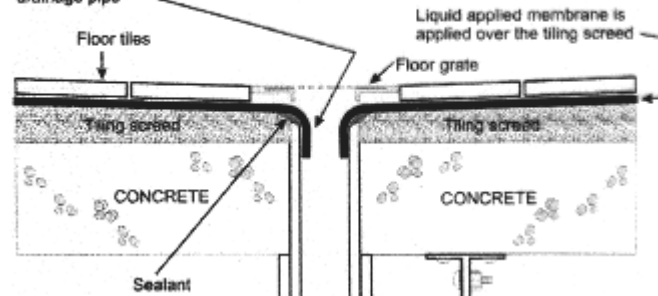

AS 3740

MEMBRANE SHOWER, BATH AND VANITY

Apply two coats of FIBREFLEX membrane to the walls and floor of the entire shower area, bath and vanity zones

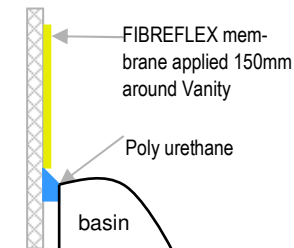

MEMBRANE FLOOR AND WALLS

Apply two coats of FIBREFLEX membrane over the entire floor area taking the membrane up the walls to approximately 100mm

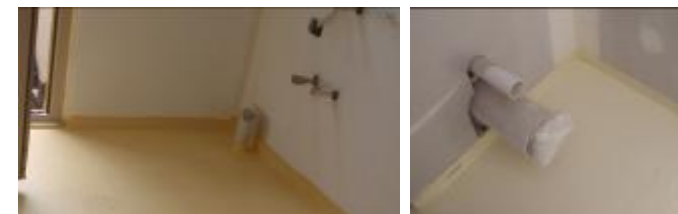

FINAL MEMBRANE OVER SCREED BEFORE TILING

Some jobs will involve a screed with a fall being placed over the membrane in preparation for tiling. We recommend another application of membrane over the screed before tiling.

