

TECHNICAL TIPS – Remedial Shower conversion for wheelchair access

NCC Objective:

O2.4.1 Wet Areas

The objective is to safeguard the occupants from illness or injury and protect the building from damage caused by the accumulation of internal moisture arising from the use of wet areas in a building.

Functional Statement:

F2.4.1 Wet Areas

A building is to be constructed to avoid the likelihood of –

- The creation of any unhealthy or dangerous conditions; or
- Damage to building elements,

Caused by dampness or water overflow from bathrooms, laundries and the like.

Acceptable Construction

Practice:

3.8.1.1 Application

Compliance with this acceptable construction practice satisfies Performance Requirements P2.4.1 for wet areas

3.8.1.2 Wet Areas

Building elements in wet areas within a building must –

- Be waterproof or water resistant in accordance with Table 3.8.1.1; and
- Comply with AS 3740

BATHROOM FOR MOBILITY IMPAIRED ACCESS WITH CORNER DRAIN

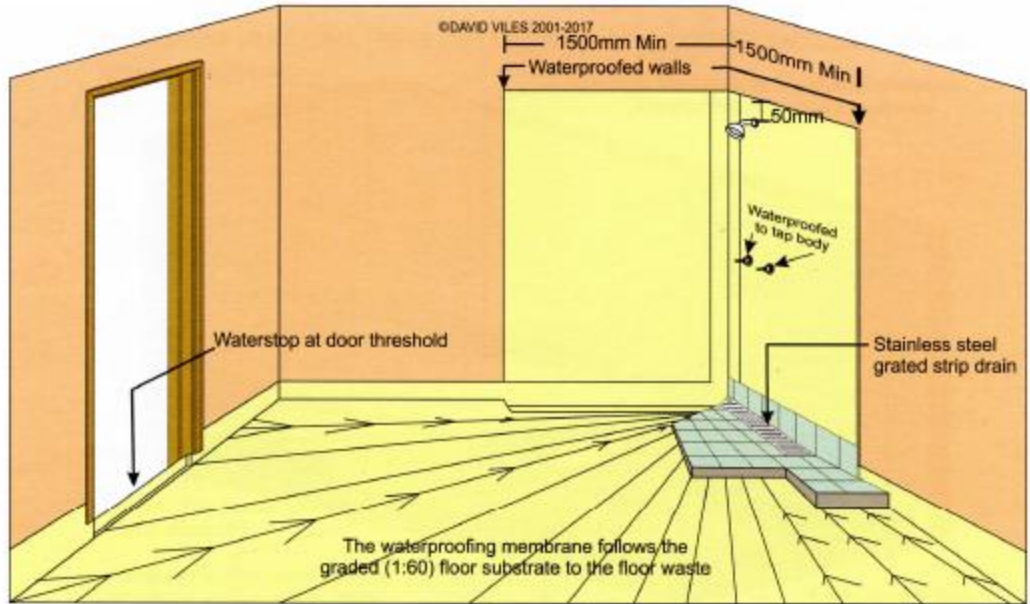

BATHROOM WITH CENTRAL FLOOR WASTE FOR MOBILITY IMPAIRED ACCESS

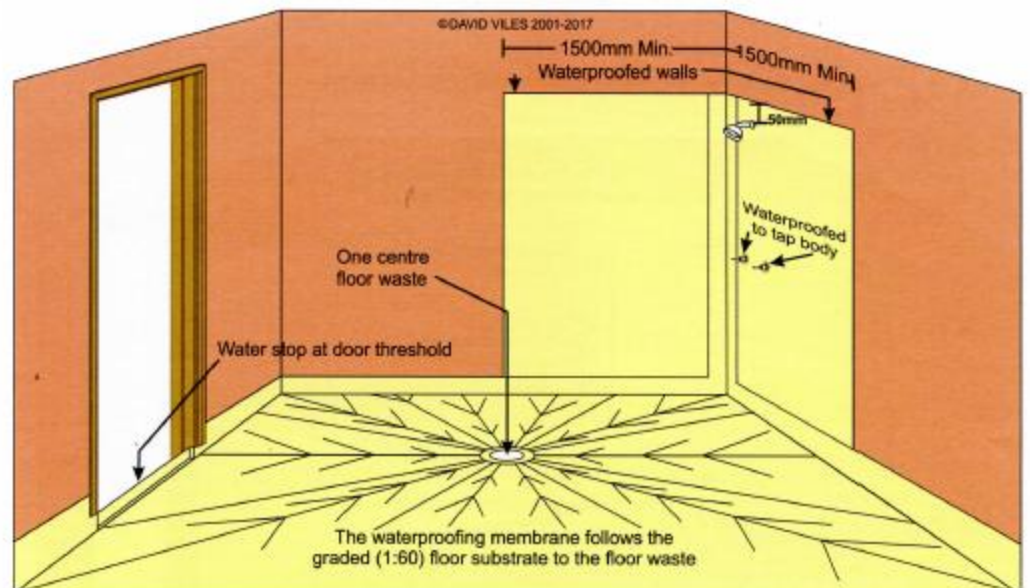

TECHNICAL TIPS – Remedial Shower conversion for wheelchair access

AS 3740: 2010

3.13.5 Unenclosed Showers

This Clause sets out requirements for two types of unenclosed showers, as follows.

- Type 1; unenclosed shower has a device that will restrict splashing during use. A waterstop shall be placed under the device and across the opening of the shower screen.
- Type 2; unenclosed shower which does not have a device that will restrict splashing (as with people with disabilities). The water stop shall be a distance of a minimum of 1500mm from the wall connection of the shower rose.

Suggested Best Practice for Compliance

- Waterproof the entire substrate floor area
- Install 'bond breaker' to all wall/floor joints, extending the membrane at least 75mm up the vertical
- Install water stops in doorways and as design requires
- Install screed to fall, with floors with no vertical separation the minimum fall required is 1:80
- Waterproof over the floor screed, vertically up the shower area to a minimum 1800mm and horizontally to a minimum 1500mm
- Detail waterproof wall penetrations and drainage flanges.

NB: Install decorative surfaces or tiles after the membrane system has had at least two days to cure.

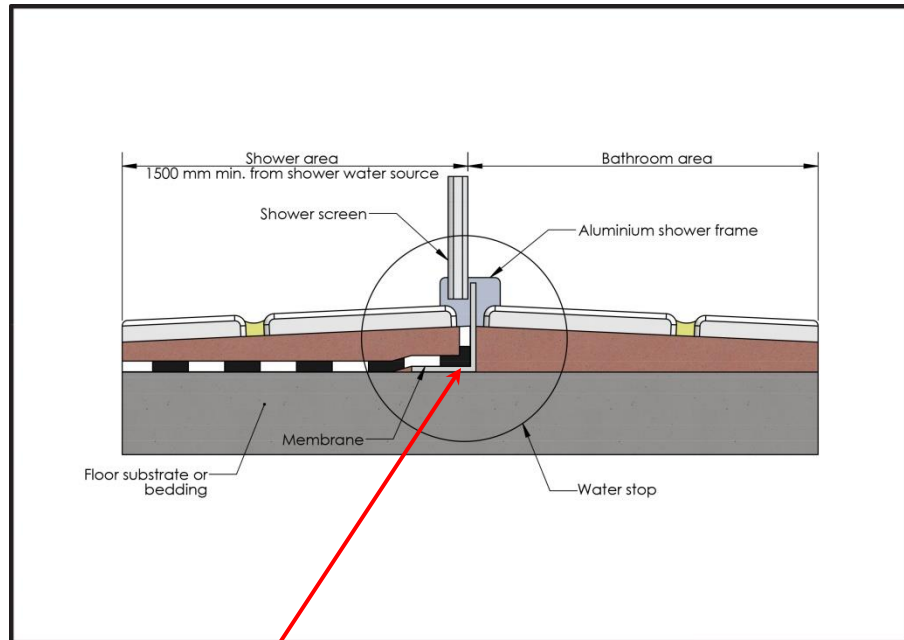

Water Stops

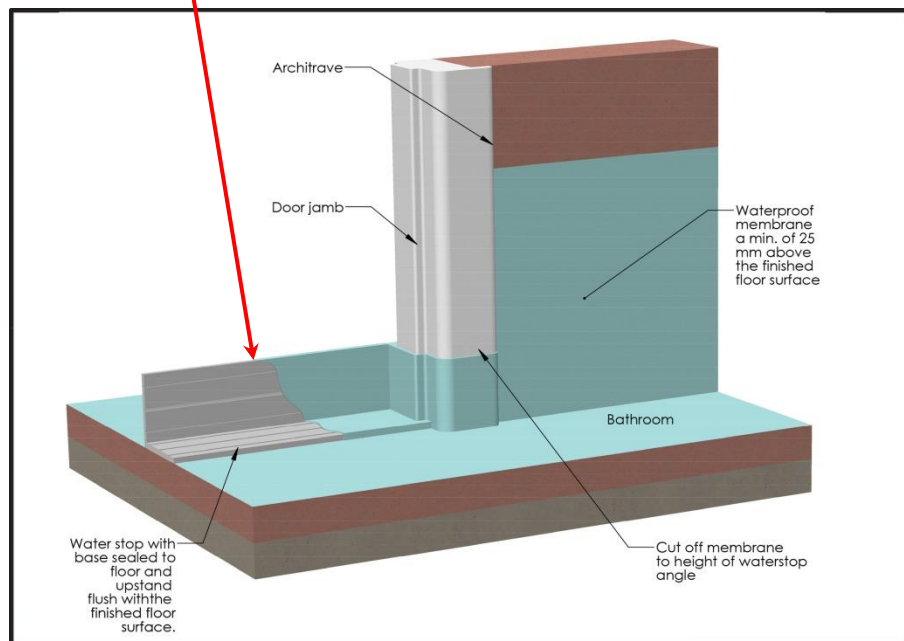

Technical drawings from AIW and MBA